

# **companion®**

TRUSTED SINCE 1941

## **CARAVAN AWNING CLOTHESLINE**

---

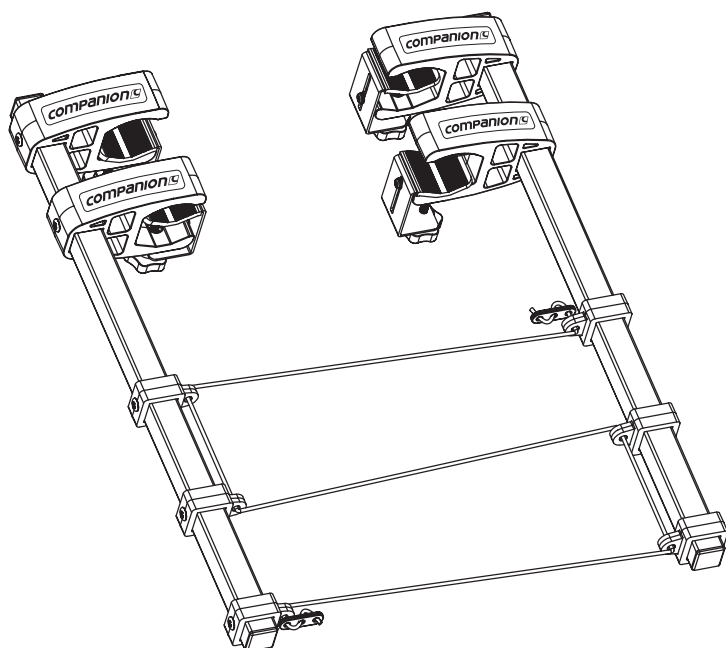

### **OWNERS MANUAL**

Model No. 10001560

**IMPORTANT:** Read these instructions for use carefully. Familiarise yourself with the awning clothesline before attaching to your caravan awning. Keep these instructions for future reference.

**IMPORTANT:** This clothesline is designed to attach to caravan awnings without the need for drilling, reducing the risk of voiding the warranty with the awning manufacturer. However, it is important to note that individual warranty terms and conditions may vary between different awning manufacturers. While the product's bracket design minimises the risk of warranty issues, it is strongly recommended to consult with the awning manufacturer before using this product to ensure awareness of any specific warranty terms and conditions. Understanding the awning manufacturer's policies will help to make informed decisions regarding the installation and use of this clothesline. Using this product is at the consumer's own risk. We will not be liable for any damage that is caused by installing the clothesline.

## COMPATIBILITY

- The brackets on this clothesline will fit onto the below awning arms:

Square awning tubes:  
20mm x 20mm, 25mm x 25mm, 35mm x 35mm

Round awning tubes:  
Diameters between 20mm – 35mm

Compatible awnings include:

Dometic  
Aussie Traveller  
Awnlux  
CareFree  
Sunburst  
Coolabah Aussie Traveller

- Individual awning arms may vary, please measure the awning arm to confirm compatibility via the measurements listed above.

## CONTENT

- A. 1 x Clothesline left side bracket
- B. 1 x Clothesline right side bracket
- C. 1 x Length of clothesline cable
- D. 2 x Cable fasteners
- E. 1 x Carry bag

Ensure all components are present before installation.

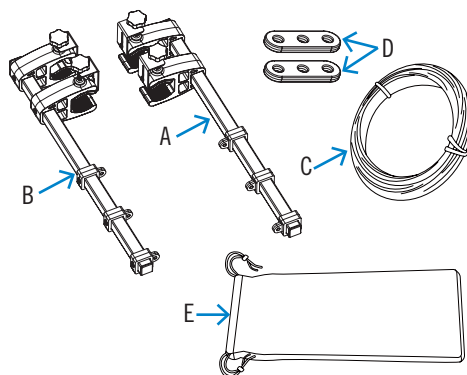

## INSTALLATION

- Step 1:** Erect the caravan awning ensuring the awning arms are moved to the end of the fabric roller. Ensure the awning is set up as per manufacturer instructions.

- Step 2:** Unscrew the bracket of the awning clothesline creating an opening to slide the bracket onto the awning arm. As the bracket is loosened, the plates will expand to allow room to place the clothesline over the awning arm.

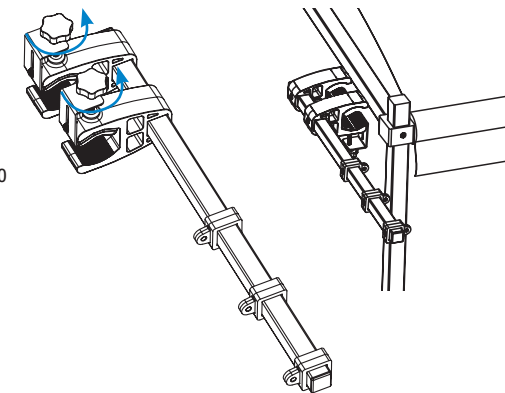

- Step 3:** Using the screws, tighten the bracket to clamp onto the awning arm. Tighten enough to ensure there is little to no movement of the clothesline bracket.

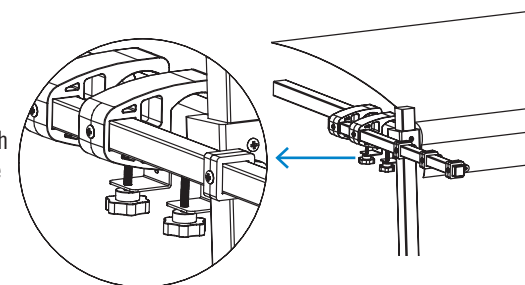

- Step 4:** Repeat process for the other side.

- Step 5:** Thread the awning clothesline cable through the tabbed eyelets. Fix cable fasteners to each end.

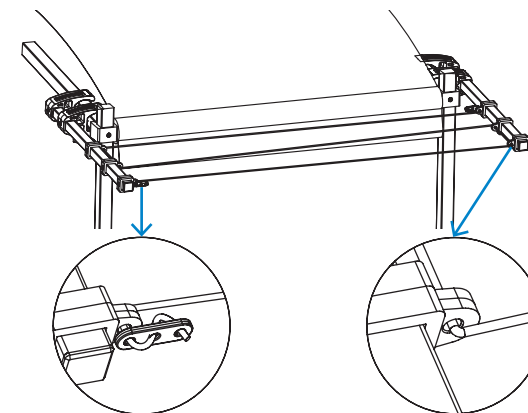

## DISASSEMBLY & STORAGE

- There is no need to remove the cable from the clothesline before packing away.
- Simply untighten the brackets attached to the caravan awning arm and fold up the clothesline.
- Use the provided carry bag to store the clothesline keeping it away from dirt, dust and to prevent damage.
- Ensure clothesline is stored in a cool, dry place.

## LINE WEIGHT CAPACITY

- The Companion awning clothesline has a capacity of 6kg. Items on the clothesline must not exceed a total weight of 6kg.
- Failure to keep within the above thresholds could cause damage to the clothesline or awning.
- Ensure weight is evenly distributed along the clothesline cable. Space out towels or clothing to cover the length of the line.
- When hanging clothes, towels or linen on the clothesline, observe if any stress or bending is occurring on the clothesline bracket. If so, remove items from clothesline.

## WARRANTY POLICY

1. Products distributed by Adventure Operations Australia Pty Ltd and any of our subsidiaries come with guarantees that cannot be excluded under the Australian Consumer Law. You are entitled to a replacement or refund for a major failure and compensation for any other reasonably foreseeable loss or damage. You are also entitled to have the goods repaired or replaced if products fail to be of acceptable quality and the failure does not amount to a major failure.
2. In addition, we warrant that this product will be free from defects in materials and workmanship under normal use as described in the published product documentation for **24 months** from the date of original purchase (Limited Warranty). This Limited Warranty is only valid and enforceable in Australia and will apply only if you have purchased the product from us or our authorised resellers.
3. To the extent permitted by the Australian Consumer Law and any applicable local law:
  - (a) our obligations under this Limited Warranty are limited to the repair, replacement or refund of covered parts that prove defective under normal use during the Limited Warranty and does not extend to any claim for damages that you or any other person may have for any loss (including without limitation consequential damages or loss of profit, freight/shipping or travel costs), or damage howsoever caused whether or not such loss or damage arises as a result of any defect in the product or from the failure or omission on our part to comply with any obligation at law;
  - (b) in replacing a defective product under the Limited Warranty, we may, at its discretion, substitute a model of equivalent nature where the exact model is unavailable;
  - (c) this Limited Warranty does not apply to damage caused by failure and damage caused by improper use and abuse, fair wear and tear, accidents, misuse (including failure to follow instructions regarding care and maintenance of the product), neglect, disassembly, alterations or external causes such as, but not limited to, water damage, exposure to sharp objects, exposure to excessive force, anomalies in the electrical current supplied to the product (if applicable), and extreme thermal or environmental conditions;
  - (d) we may elect, at our discretion and as an alternative to repairing or replacing a defective part to refund the cost of the relevant product upon it being returned to us; and
  - (e) this Limited Warranty does not extend to any products acquired for the purposes of re-supply, or for use in a manufacturing, or repair processes.
4. This warranty may be claimed by:
  - returning the product to its place of purchase, with a detailed proof-of-purchase clearly showing the date and detail of the purchase;
5. If you have any questions concerning this warranty policy, you may contact us in writing:
  - Adventure Operations, 71 Charles Ulm Place, Eagle Farm, 4009 QLD, or by email: [warranty@adventureoperations.com](mailto:warranty@adventureoperations.com) or visit our website: <https://www.companionoutdoor.com>

TO THE EXTENT PERMITTED BY LAW, ADVENTURE OPERATIONS AUSTRALIA PTY LTD, ITS SUBSIDIARIES AND ITS VENDORS DISCLAIM ANY IMPLIED WARRANTIES OF MERCHANTABILITY OR FITNESS FOR A PARTICULAR PURPOSE OR ANY SIMILAR STANDARD IMPOSED BY APPLICABLE LEGISLATION AND ADVENTURE OPERATIONS AUSTRALIA PTY LTD AND ITS SUBSIDIARIES' RESPONSIBILITY TO REPAIR, REPLACE, OR OFFER A REFUND FOR DEFECTIVE PRODUCTS IS THE SOLE AND EXCLUSIVE REMEDY PROVIDED TO ITS CUSTOMERS UNDER THIS DOCUMENT.

## NOTES

[illegible][illegible]

WARRANTY - For details see [www.companionoutdoor.com](http://www.companionoutdoor.com)

Companion® is a registered trademark of  
**Adventure Trading Australia Pty Ltd**

Designed by:  
**Adventure Trading Australia Pty Ltd**  
71 Charles Ulm Place,  
Eagle Farm, QLD 4009  
AUSTRALIA



Made in China